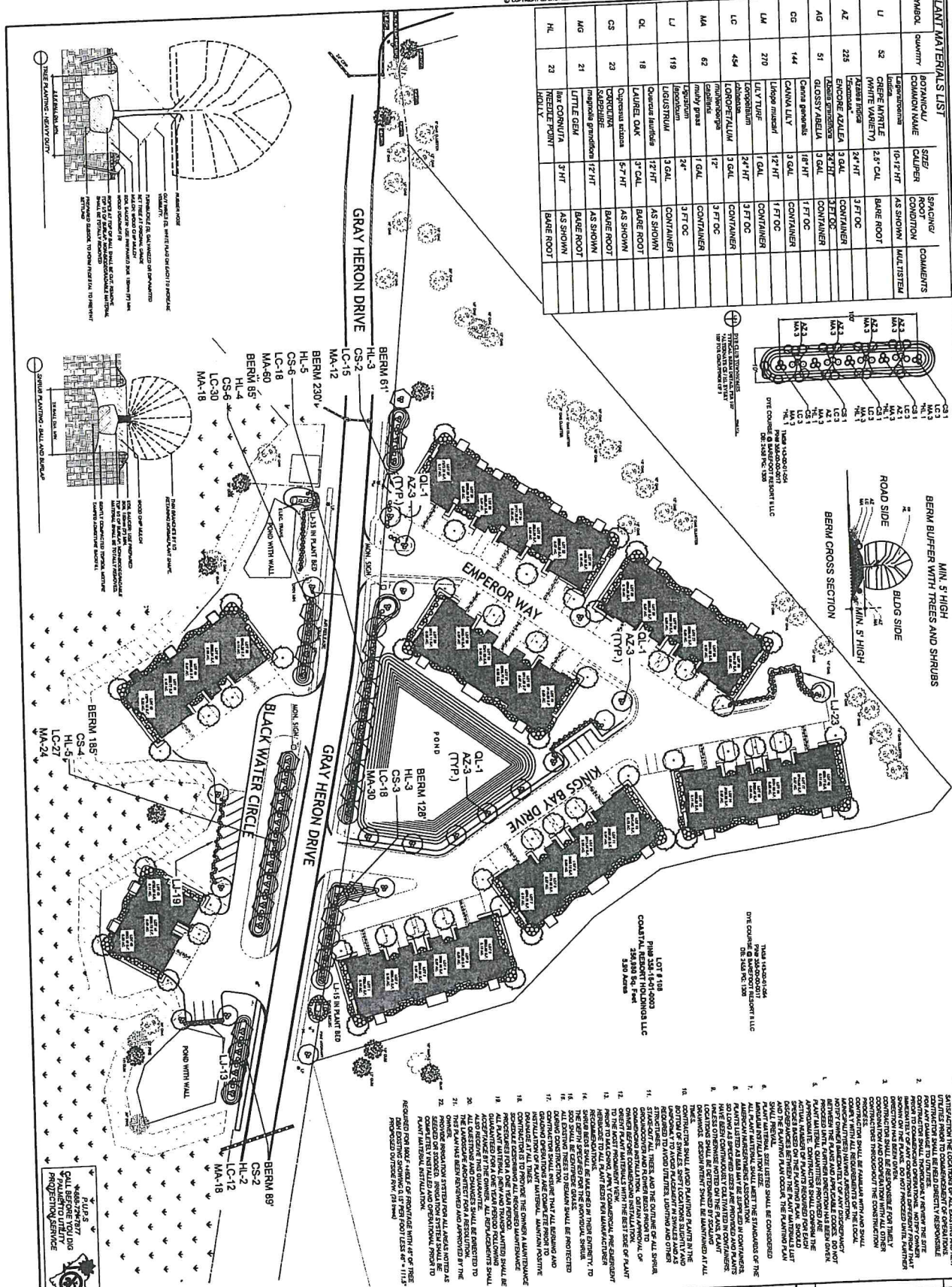

**EXHIBIT "C"**

Landscaped Berm Plan

PLANT MATERIALS LIST	SYMBOL	QUANTITY	COMMON NAME	SIZE/CLIPPER	ROOT CONDITION	COMMENTS
U	52	1	CRAB APPLE	10-12" HT	AS SHOWN	MULTISTEM
A2	225	1	CRAB APPLE	24" HT	3 FT OC	CONTAINER
AG	51	1	CRAB APPLE	36" HT	3 FT OC	CONTAINER
CG	144	1	CRAB APPLE	48" HT	3 FT OC	CONTAINER
LM	270	1	CRAB APPLE	60" HT	3 FT OC	CONTAINER
LC	454	1	CRAB APPLE	72" HT	3 FT OC	CONTAINER
MA	62	1	CRAB APPLE	84" HT	3 FT OC	CONTAINER
L	118	1	CRAB APPLE	96" HT	3 FT OC	CONTAINER
OL	18	1	CRAB APPLE	108" HT	3 FT OC	CONTAINER
CS	22	1	CRAB APPLE	120" HT	3 FT OC	CONTAINER
MG	21	1	CRAB APPLE	132" HT	3 FT OC	CONTAINER
HL	23	1	CRAB APPLE	144" HT	3 FT OC	CONTAINER



GENERAL NOTES

1. CONTRACTOR SHALL OBTAIN ALL NECESSARY PERMITS AND APPROVALS FROM THE APPROPRIATE AGENCIES.
2. CONTRACTOR SHALL MAINTAIN ACCESS TO ALL ADJACENT PROPERTIES AT ALL TIMES.
3. CONTRACTOR SHALL MAINTAIN ACCESS TO ALL ADJACENT PROPERTIES AT ALL TIMES.
4. CONTRACTOR SHALL MAINTAIN ACCESS TO ALL ADJACENT PROPERTIES AT ALL TIMES.
5. CONTRACTOR SHALL MAINTAIN ACCESS TO ALL ADJACENT PROPERTIES AT ALL TIMES.
6. CONTRACTOR SHALL MAINTAIN ACCESS TO ALL ADJACENT PROPERTIES AT ALL TIMES.
7. CONTRACTOR SHALL MAINTAIN ACCESS TO ALL ADJACENT PROPERTIES AT ALL TIMES.
8. CONTRACTOR SHALL MAINTAIN ACCESS TO ALL ADJACENT PROPERTIES AT ALL TIMES.
9. CONTRACTOR SHALL MAINTAIN ACCESS TO ALL ADJACENT PROPERTIES AT ALL TIMES.
10. CONTRACTOR SHALL MAINTAIN ACCESS TO ALL ADJACENT PROPERTIES AT ALL TIMES.
11. CONTRACTOR SHALL MAINTAIN ACCESS TO ALL ADJACENT PROPERTIES AT ALL TIMES.
12. CONTRACTOR SHALL MAINTAIN ACCESS TO ALL ADJACENT PROPERTIES AT ALL TIMES.
13. CONTRACTOR SHALL MAINTAIN ACCESS TO ALL ADJACENT PROPERTIES AT ALL TIMES.
14. CONTRACTOR SHALL MAINTAIN ACCESS TO ALL ADJACENT PROPERTIES AT ALL TIMES.
15. CONTRACTOR SHALL MAINTAIN ACCESS TO ALL ADJACENT PROPERTIES AT ALL TIMES.
16. CONTRACTOR SHALL MAINTAIN ACCESS TO ALL ADJACENT PROPERTIES AT ALL TIMES.
17. CONTRACTOR SHALL MAINTAIN ACCESS TO ALL ADJACENT PROPERTIES AT ALL TIMES.
18. CONTRACTOR SHALL MAINTAIN ACCESS TO ALL ADJACENT PROPERTIES AT ALL TIMES.
19. CONTRACTOR SHALL MAINTAIN ACCESS TO ALL ADJACENT PROPERTIES AT ALL TIMES.
20. CONTRACTOR SHALL MAINTAIN ACCESS TO ALL ADJACENT PROPERTIES AT ALL TIMES.
21. CONTRACTOR SHALL MAINTAIN ACCESS TO ALL ADJACENT PROPERTIES AT ALL TIMES.
22. CONTRACTOR SHALL MAINTAIN ACCESS TO ALL ADJACENT PROPERTIES AT ALL TIMES.
23. CONTRACTOR SHALL MAINTAIN ACCESS TO ALL ADJACENT PROPERTIES AT ALL TIMES.
24. CONTRACTOR SHALL MAINTAIN ACCESS TO ALL ADJACENT PROPERTIES AT ALL TIMES.
25. CONTRACTOR SHALL MAINTAIN ACCESS TO ALL ADJACENT PROPERTIES AT ALL TIMES.
26. CONTRACTOR SHALL MAINTAIN ACCESS TO ALL ADJACENT PROPERTIES AT ALL TIMES.
27. CONTRACTOR SHALL MAINTAIN ACCESS TO ALL ADJACENT PROPERTIES AT ALL TIMES.
28. CONTRACTOR SHALL MAINTAIN ACCESS TO ALL ADJACENT PROPERTIES AT ALL TIMES.
29. CONTRACTOR SHALL MAINTAIN ACCESS TO ALL ADJACENT PROPERTIES AT ALL TIMES.
30. CONTRACTOR SHALL MAINTAIN ACCESS TO ALL ADJACENT PROPERTIES AT ALL TIMES.
31. CONTRACTOR SHALL MAINTAIN ACCESS TO ALL ADJACENT PROPERTIES AT ALL TIMES.
32. CONTRACTOR SHALL MAINTAIN ACCESS TO ALL ADJACENT PROPERTIES AT ALL TIMES.
33. CONTRACTOR SHALL MAINTAIN ACCESS TO ALL ADJACENT PROPERTIES AT ALL TIMES.
34. CONTRACTOR SHALL MAINTAIN ACCESS TO ALL ADJACENT PROPERTIES AT ALL TIMES.
35. CONTRACTOR SHALL MAINTAIN ACCESS TO ALL ADJACENT PROPERTIES AT ALL TIMES.
36. CONTRACTOR SHALL MAINTAIN ACCESS TO ALL ADJACENT PROPERTIES AT ALL TIMES.
37. CONTRACTOR SHALL MAINTAIN ACCESS TO ALL ADJACENT PROPERTIES AT ALL TIMES.
38. CONTRACTOR SHALL MAINTAIN ACCESS TO ALL ADJACENT PROPERTIES AT ALL TIMES.
39. CONTRACTOR SHALL MAINTAIN ACCESS TO ALL ADJACENT PROPERTIES AT ALL TIMES.
40. CONTRACTOR SHALL MAINTAIN ACCESS TO ALL ADJACENT PROPERTIES AT ALL TIMES.
41. CONTRACTOR SHALL MAINTAIN ACCESS TO ALL ADJACENT PROPERTIES AT ALL TIMES.
42. CONTRACTOR SHALL MAINTAIN ACCESS TO ALL ADJACENT PROPERTIES AT ALL TIMES.
43. CONTRACTOR SHALL MAINTAIN ACCESS TO ALL ADJACENT PROPERTIES AT ALL TIMES.
44. CONTRACTOR SHALL MAINTAIN ACCESS TO ALL ADJACENT PROPERTIES AT ALL TIMES.
45. CONTRACTOR SHALL MAINTAIN ACCESS TO ALL ADJACENT PROPERTIES AT ALL TIMES.
46. CONTRACTOR SHALL MAINTAIN ACCESS TO ALL ADJACENT PROPERTIES AT ALL TIMES.
47. CONTRACTOR SHALL MAINTAIN ACCESS TO ALL ADJACENT PROPERTIES AT ALL TIMES.
48. CONTRACTOR SHALL MAINTAIN ACCESS TO ALL ADJACENT PROPERTIES AT ALL TIMES.
49. CONTRACTOR SHALL MAINTAIN ACCESS TO ALL ADJACENT PROPERTIES AT ALL TIMES.
50. CONTRACTOR SHALL MAINTAIN ACCESS TO ALL ADJACENT PROPERTIES AT ALL TIMES.
51. CONTRACTOR SHALL MAINTAIN ACCESS TO ALL ADJACENT PROPERTIES AT ALL TIMES.
52. CONTRACTOR SHALL MAINTAIN ACCESS TO ALL ADJACENT PROPERTIES AT ALL TIMES.
53. CONTRACTOR SHALL MAINTAIN ACCESS TO ALL ADJACENT PROPERTIES AT ALL TIMES.
54. CONTRACTOR SHALL MAINTAIN ACCESS TO ALL ADJACENT PROPERTIES AT ALL TIMES.
55. CONTRACTOR SHALL MAINTAIN ACCESS TO ALL ADJACENT PROPERTIES AT ALL TIMES.
56. CONTRACTOR SHALL MAINTAIN ACCESS TO ALL ADJACENT PROPERTIES AT ALL TIMES.
57. CONTRACTOR SHALL MAINTAIN ACCESS TO ALL ADJACENT PROPERTIES AT ALL TIMES.
58. CONTRACTOR SHALL MAINTAIN ACCESS TO ALL ADJACENT PROPERTIES AT ALL TIMES.
59. CONTRACTOR SHALL MAINTAIN ACCESS TO ALL ADJACENT PROPERTIES AT ALL TIMES.
60. CONTRACTOR SHALL MAINTAIN ACCESS TO ALL ADJACENT PROPERTIES AT ALL TIMES.
61. CONTRACTOR SHALL MAINTAIN ACCESS TO ALL ADJACENT PROPERTIES AT ALL TIMES.
62. CONTRACTOR SHALL MAINTAIN ACCESS TO ALL ADJACENT PROPERTIES AT ALL TIMES.
63. CONTRACTOR SHALL MAINTAIN ACCESS TO ALL ADJACENT PROPERTIES AT ALL TIMES.
64. CONTRACTOR SHALL MAINTAIN ACCESS TO ALL ADJACENT PROPERTIES AT ALL TIMES.
65. CONTRACTOR SHALL MAINTAIN ACCESS TO ALL ADJACENT PROPERTIES AT ALL TIMES.
66. CONTRACTOR SHALL MAINTAIN ACCESS TO ALL ADJACENT PROPERTIES AT ALL TIMES.
67. CONTRACTOR SHALL MAINTAIN ACCESS TO ALL ADJACENT PROPERTIES AT ALL TIMES.
68. CONTRACTOR SHALL MAINTAIN ACCESS TO ALL ADJACENT PROPERTIES AT ALL TIMES.
69. CONTRACTOR SHALL MAINTAIN ACCESS TO ALL ADJACENT PROPERTIES AT ALL TIMES.
70. CONTRACTOR SHALL MAINTAIN ACCESS TO ALL ADJACENT PROPERTIES AT ALL TIMES.
71. CONTRACTOR SHALL MAINTAIN ACCESS TO ALL ADJACENT PROPERTIES AT ALL TIMES.
72. CONTRACTOR SHALL MAINTAIN ACCESS TO ALL ADJACENT PROPERTIES AT ALL TIMES.
73. CONTRACTOR SHALL MAINTAIN ACCESS TO ALL ADJACENT PROPERTIES AT ALL TIMES.
74. CONTRACTOR SHALL MAINTAIN ACCESS TO ALL ADJACENT PROPERTIES AT ALL TIMES.
75. CONTRACTOR SHALL MAINTAIN ACCESS TO ALL ADJACENT PROPERTIES AT ALL TIMES.
76. CONTRACTOR SHALL MAINTAIN ACCESS TO ALL ADJACENT PROPERTIES AT ALL TIMES.
77. CONTRACTOR SHALL MAINTAIN ACCESS TO ALL ADJACENT PROPERTIES AT ALL TIMES.
78. CONTRACTOR SHALL MAINTAIN ACCESS TO ALL ADJACENT PROPERTIES AT ALL TIMES.
79. CONTRACTOR SHALL MAINTAIN ACCESS TO ALL ADJACENT PROPERTIES AT ALL TIMES.
80. CONTRACTOR SHALL MAINTAIN ACCESS TO ALL ADJACENT PROPERTIES AT ALL TIMES.
81. CONTRACTOR SHALL MAINTAIN ACCESS TO ALL ADJACENT PROPERTIES AT ALL TIMES.
82. CONTRACTOR SHALL MAINTAIN ACCESS TO ALL ADJACENT PROPERTIES AT ALL TIMES.
83. CONTRACTOR SHALL MAINTAIN ACCESS TO ALL ADJACENT PROPERTIES AT ALL TIMES.
84. CONTRACTOR SHALL MAINTAIN ACCESS TO ALL ADJACENT PROPERTIES AT ALL TIMES.
85. CONTRACTOR SHALL MAINTAIN ACCESS TO ALL ADJACENT PROPERTIES AT ALL TIMES.
86. CONTRACTOR SHALL MAINTAIN ACCESS TO ALL ADJACENT PROPERTIES AT ALL TIMES.
87. CONTRACTOR SHALL MAINTAIN ACCESS TO ALL ADJACENT PROPERTIES AT ALL TIMES.
88. CONTRACTOR SHALL MAINTAIN ACCESS TO ALL ADJACENT PROPERTIES AT ALL TIMES.
89. CONTRACTOR SHALL MAINTAIN ACCESS TO ALL ADJACENT PROPERTIES AT ALL TIMES.
90. CONTRACTOR SHALL MAINTAIN ACCESS TO ALL ADJACENT PROPERTIES AT ALL TIMES.
91. CONTRACTOR SHALL MAINTAIN ACCESS TO ALL ADJACENT PROPERTIES AT ALL TIMES.
92. CONTRACTOR SHALL MAINTAIN ACCESS TO ALL ADJACENT PROPERTIES AT ALL TIMES.
93. CONTRACTOR SHALL MAINTAIN ACCESS TO ALL ADJACENT PROPERTIES AT ALL TIMES.
94. CONTRACTOR SHALL MAINTAIN ACCESS TO ALL ADJACENT PROPERTIES AT ALL TIMES.
95. CONTRACTOR SHALL MAINTAIN ACCESS TO ALL ADJACENT PROPERTIES AT ALL TIMES.
96. CONTRACTOR SHALL MAINTAIN ACCESS TO ALL ADJACENT PROPERTIES AT ALL TIMES.
97. CONTRACTOR SHALL MAINTAIN ACCESS TO ALL ADJACENT PROPERTIES AT ALL TIMES.
98. CONTRACTOR SHALL MAINTAIN ACCESS TO ALL ADJACENT PROPERTIES AT ALL TIMES.
99. CONTRACTOR SHALL MAINTAIN ACCESS TO ALL ADJACENT PROPERTIES AT ALL TIMES.
100. CONTRACTOR SHALL MAINTAIN ACCESS TO ALL ADJACENT PROPERTIES AT ALL TIMES.

P.L.P. & S.  
 4400 74th Street  
 Suite 100  
 Myrtle Beach, SC 29577  
 Phone: 843.237.1001  
 Fax: 843.237.1002  
 Email: info@plpands.com  
 Website: www.plpands.com

DYE CLUB TOWNHOMES  
 Horry County, North Myrtle Beach, SC  
 PREPARED FOR  
**D.R. HORTON**  
 STREET TREE AND BERM LANDSCAPE PLAN

**ENGINEERING**  
 P.O. BOX 2666  
 PAULSTON ISLAND, SC 29565  
 PHONE: 843.237.1001  
 www.G3Engineering.com



NO.	DATE	REVISION
1	01/15/2010	REV. PER PLAN CORRECTIONS
2	01/15/2010	REV. PER PLAN CORRECTIONS
3	01/15/2010	REV. PER PLAN CORRECTIONS
4	01/15/2010	REV. PER PLAN CORRECTIONS
5	01/15/2010	REV. PER PLAN CORRECTIONS
6	01/15/2010	REV. PER PLAN CORRECTIONS
7	01/15/2010	REV. PER PLAN CORRECTIONS
8	01/15/2010	REV. PER PLAN CORRECTIONS
9	01/15/2010	REV. PER PLAN CORRECTIONS
10	01/15/2010	REV. PER PLAN CORRECTIONS

STATE OF SOUTH CAROLINA

**AFFIDAVIT FOR TAXABLE OR EXEMPT TRANSFERS**

COUNTY OF HORRY

PERSONALLY appeared before me the undersigned, who, being duly sworn, deposes and says:

1. I have read the information on this Affidavit and I understand such information.
2. The property being transferred is identified as an Easement over Gray Heron Drive, a private street located in Barefoot Resort, North Myrtle Beach, South Carolina, was transferred by **THE DYE ESTATES HOMEOWNERS ASSOCIATION, INC.** to **COASTAL RESORT HOLDINGS, LLC and D.R. HORTON, INC.**, on the \_\_\_\_ day of \_\_\_\_\_, 2018.
3. Check one of the following: *The DEED is*
  - (a) \_\_\_\_ subject to the deed recording fee as a transfer for consideration paid or to be paid in money or money's worth.
  - (b) \_\_\_\_ subject to the deed recording fee as a transfer between a corporation, a partnership, or other entity and a stockholder, partner, or owner of the entity, or is a transfer to a trust or as a distribution to a trust beneficiary.
  - (c)   X   EXEMPT from the deed recording fee because (Exemption # \_\_\_\_)  
(Explanation if required                     Exemption #1 (Value \$100 or less)                    .)  
(If exempt, please skip items 4-7, and go to item 8 of this affidavit.)
4. Check one of the following if either item 3(a) or item 3(b) above has been checked.
  - (a) \_\_\_\_ The fee is computed on the consideration paid or to be paid in money or money's worth in the amount of \$ \_\_\_\_.
  - (b) \_\_\_\_ The fee is computed on the fair market value of the realty which is \$ \_\_\_\_.
  - (c) \_\_\_\_ The fee is computed on the fair market value of the realty as established for property tax purposes which is \$ \_\_\_\_.
5. Check YES \_\_\_\_ or NO   X   to the following: A lien or encumbrance existed on the land, tenement, or realty before the transfer and remained on the land, tenement, or realty after the transfer. If "YES", the amount of the outstanding balance of this lien or encumbrance is \$ \_\_\_\_.
6. The DEED Recording Fee is computed as follows:
  - (a) \_\_\_\_ \$ \_\_\_\_ the amount listed in item 4 above
  - (b) \_\_\_\_ \$ \_\_\_\_ the amount listed in item 5 above (no amount place zero)
  - (c) \_\_\_\_ \$ \_\_\_\_ subtract line 6(b) from line 6(a) and place the result.
7. The deed recording fee due is based on the amount listed on Line 6(c) above and the deed recording fee due is: \_\_\_\_
8. As required by Code Section 12-24-70, I state that I am a responsible person who was connected with the transaction as: **GRANTEE**.
9. I understand that a person required to furnish this affidavit who willfully furnishes a false or fraudulent affidavit is guilty of a misdemeanor and, upon conviction, must be fined not more than one thousand dollars or imprisoned not more than one year, or both.

**D.R. HORTON, INC.**, a Delaware corporation

Sworn to before me this  
\_\_\_\_ day of \_\_\_\_\_, 2018.

\_\_\_\_\_  
Notary Public for South Carolina  
My Commission Expires: \_\_\_\_\_

By: \_\_\_\_\_  
Its: \_\_\_\_\_

## **EXHIBIT “E”**

### **Detailed Description of Blackwater Plans (Miniaturized Copies of which are also attached hereto)**

1. “Site Development Plans for Dye Club Townhomes Phases I and II”, prepared by G3 Engineering, Project No.: 16016, last revised May 31, 2018.
2. The following Architectural Plans:
  - (a) “Barefoot Dye Town Homes 3-Unit Building” prepared for DR Horton by Urban Architectural Group, dated March 28, 2018.
  - (b) “Barefoot Dye Town Homes 5-Unit Building” prepared for DR Horton by Urban Architectural Group, dated March 28, 2018.
  - (c) “Barefoot Dye Town Homes 6-Unit Building” prepared for DR Horton by Urban Architectural Group, dated March 28, 2018.
  - (d) “Barefoot Dye Town Homes 7-Unit Building” prepared for DR Horton by Urban Architectural Group, dated March 28, 2018.
3. The following Materials, in the following colors:
  - (a) Shutters – Black Raised Panel.
  - (b) Exterior Door – Holy City Red DCR038.
  - (c) Siding and Privacy Panel Fence – Fiber Cement, Color Antique Pewter DCR057.
  - (d) Window, Corner and Trim – Fiber Cement, Color White.
  - (e) Privacy Panel Fence – 6’ x 6’ Simtek in Ashland Style, Color Nantucket Gray.
  - (f) Brick – Meridian Brick, Capers Island Queen Size.
  - (g) Accent Roof – Standing Seam, Color Matte Black.
  - (h) Architectural Shingles – 30 Year Shingles, Color Weatherwood.
  - (i) Garage Doors – Wayne Dalton Charleston Style 9405 Door with Stockbridge Impact Glass.
  - (j) Any ponds or lakes that are enclosed by fencing shall be enclosed by black aluminum fencing, with square posts, not exceeding Four (4) feet in height, unless otherwise required by the City of North Myrtle Beach.

4. Dye Club Townhomes, Horry County, North Myrtle Beach, SC, prepared for D.R. Horton "Right of Way Layout", prepared by G3 Engineering, last revised September 15, 2017.
5. Dye Club Townhomes, Horry County, North Myrtle Beach, SC, prepared for D.R. Horton "Street Tree and Berm Landscape Plan", prepared by G3 Engineering, last revised June 1, 2018.
6. Horton has also provided a Development Timeline, which is attached hereto as a part of this Exhibit "E", which timeline is subject to change from time to time, Horton agreeing to provide updates of such Development Timeline, for approval by the Dye Estates HOA, such approval not to be unreasonably withheld or delayed. The purpose of the Development Timeline is to indicate the schedule on which development of the Blackwater Property is anticipated to occur, the commencement of which will begin within Thirty (30) days of final approval of the Blackwater Plans by the City of North Myrtle Beach.



PROJECT CONTRACTS	
CLIENT	
MADE: D.A. HORTON CONTACT: BRAD BRIDGEC ADDRESS: 4291 BELLE TRIERE BLVD. NORTHE BEACH, SC 29573 PHONE: (803) 255-4400	
SURVEYOR	
MADE: ROBERT A. WENGER AND ASSOCIATES, INC. CONTACT: ERIC WALSON P.E. ADDRESS: 778 3TH AVENUE, SOUTH WENTLE BEACH, SC 29577 PHONE: (803) 725-6652	
CITY OF NORTH MYRTLE BEACH	
DEPT: ZONING CONTACT: PAUL ELBERT ADDRESS: 118 SECOND AVE. SOUTH NORTH MYRTLE BEACH, SC 29582 PHONE: (803) 725-5555	
DEPT: PLANNING CONTACT: ANDREW RUCKER ADDRESS: 118 SECOND AVE. SOUTH NORTH MYRTLE BEACH, SC 29582 PHONE: (803) 725-5972	
DEPT: HOUSING CONTACT: KEVIN RAYMOND, PLANNING ADDRESS: 118 SECOND AVE. SOUTH NORTH MYRTLE BEACH, SC 29582 PHONE: (803) 725-5254	
DEPT: STATIONMASTER CONTACT: PHOEBE DUMPER ADDRESS: 118 SECOND AVE. SOUTH NORTH MYRTLE BEACH, SC 29582 PHONE: (803) 725-5552	

LOCATED IN THE BAREFOOT ESTATES COMMUNITY,  
CITY OF NORTH MYRTLE BEACH, Horry County, South Carolina

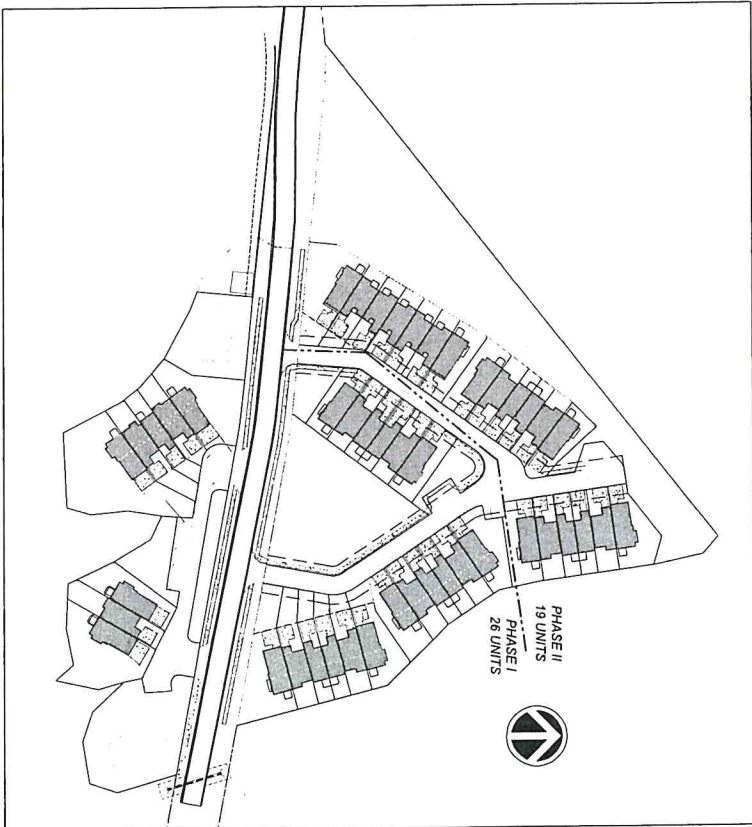

SHEET SCHEDULE				
SHEET #	SHEET TITLE	ORIGINAL DATE	REV. DATE	REVISION
C-1	COVER	4/10/2011	4/10/2011	
PM-1	PRELIMINARY PLAN	4/20/2011	4/20/2011	
C-2	GENERAL NOTES AND EROSION CONTROL	4/10/2011	4/20/2011	
C-3	SEEDING AND EROSION CONTROL PLAN - STAGE 1	4/10/2011	4/20/2011	
C-3.1	SEEDING AND EROSION CONTROL PLAN - STAGE 2	4/10/2011	4/20/2011	
C-4	SEEDING AND EROSION CONTROL PLAN - STAGES 3 & 4	4/10/2011	4/20/2011	
C-5	WATER AND SLOPE STABILIZATION PLAN / WROGUE	4/10/2011	4/20/2011	
C-6	WATER DISTRIBUTION DETAILS	4/10/2011	4/20/2011	
C-8	SLUMPY SEWER DETAILS	4/10/2011	4/20/2011	
C-10	GRADING AND DRAINAGE PLAN	4/10/2011	4/20/2011	
C-11	GRADING AND DRAINAGE PROFILES	4/10/2011	4/20/2011	
C-12	WROGUE PLAN / WROGUE	4/10/2011	4/20/2011	
C-13	GRADING AND DRAINAGE DETAILS	4/10/2011	4/20/2011	
C-14	LANDSCAPE PLANT DETAILS	4/10/2011	4/20/2011	
C-15	LANDSCAPE PLANT DETAILS	4/10/2011	4/20/2011	
C-16	PHASE 2A AND 2B DETAILS	4/10/2011	4/20/2011	
C-17	PHASE 2A AND 2B DETAILS	4/10/2011	4/20/2011	
C-18	PHASE 2A AND 2B DETAILS	4/10/2011	4/20/2011	
C-19	PHASE 2A AND 2B DETAILS	4/10/2011	4/20/2011	
C-20	PHASE 2A AND 2B DETAILS	4/10/2011	4/20/2011	
C-21	PHASE 2A AND 2B DETAILS	4/10/2011	4/20/2011	
C-22	PHASE 2A AND 2B DETAILS	4/10/2011	4/20/2011	
C-23	PHASE 2A AND 2B DETAILS	4/10/2011	4/20/2011	
C-24	PHASE 2A AND 2B DETAILS	4/10/2011	4/20/2011	
C-25	PHASE 2A AND 2B DETAILS	4/10/2011	4/20/2011	
C-26	PHASE 2A AND 2B DETAILS	4/10/2011	4/20/2011	
C-27	PHASE 2A AND 2B DETAILS	4/10/2011	4/20/2011	
C-28	PHASE 2A AND 2B DETAILS	4/10/2011	4/20/2011	
C-29	PHASE 2A AND 2B DETAILS	4/10/2011	4/20/2011	
C-30	PHASE 2A AND 2B DETAILS	4/10/2011	4/20/2011	
C-31	PHASE 2A AND 2B DETAILS	4/10/2011	4/20/2011	
C-32	PHASE 2A AND 2B DETAILS	4/10/2011	4/20/2011	
C-33	PHASE 2A AND 2B DETAILS	4/10/2011	4/20/2011	
C-34	PHASE 2A AND 2B DETAILS	4/10/2011	4/20/2011	
C-35	PHASE 2A AND 2B DETAILS	4/10/2011	4/20/2011	
C-36	PHASE 2A AND 2B DETAILS	4/10/2011	4/20/2011	
C-37	PHASE 2A AND 2B DETAILS	4/10/2011	4/20/2011	
C-38	PHASE 2A AND 2B DETAILS	4/10/2011	4/20/2011	
C-39	PHASE 2A AND 2B DETAILS	4/10/2011	4/20/2011	
C-40	PHASE 2A AND 2B DETAILS	4/10/2011	4/20/2011	
C-41	PHASE 2A AND 2B DETAILS	4/10/2011	4/20/2011	
C-42	PHASE 2A AND 2B DETAILS	4/10/2011	4/20/2011	
C-43	PHASE 2A AND 2B DETAILS	4/10/2011	4/20/2011	
C-44	PHASE 2A AND 2B DETAILS	4/10/2011	4/20/2011	
C-45	PHASE 2A AND 2B DETAILS	4/10/2011	4/20/2011	
C-46	PHASE 2A AND 2B DETAILS	4/10/2011	4/20/2011	
C-47	PHASE 2A AND 2B DETAILS	4/10/2011	4/20/2011	
C-48	PHASE 2A AND 2B DETAILS	4/10/2011	4/20/2011	
C-49	PHASE 2A AND 2B DETAILS	4/10/2011	4/20/2011	
C-50	PHASE 2A AND 2B DETAILS	4/10/2011	4/20/2011	
C-51	PHASE 2A AND 2B DETAILS	4/10/2011	4/20/2011	
C-52	PHASE 2A AND 2B DETAILS	4/10/2011	4/20/2011	
C-53	PHASE 2A AND 2B DETAILS	4/10/2011	4/20/2011	
C-54	PHASE 2A AND 2B DETAILS	4/10/2011	4/20/2011	
C-55	PHASE 2A AND 2B DETAILS	4/10/2011	4/20/2011	
C-56	PHASE 2A AND 2B DETAILS	4/10/2011	4/20/2011	
C-57	PHASE 2A AND 2B DETAILS	4/10/2011	4/20/2011	
C-58	PHASE 2A AND 2B DETAILS	4/10/2011	4/20/2011	
C-59	PHASE 2A AND 2B DETAILS	4/10/2011	4/20/2011	
C-60	PHASE 2A AND 2B DETAILS	4/10/2011	4/20/2011	
C-61	PHASE 2A AND 2B DETAILS	4/10/2011	4/20/2011	
C-62	PHASE 2A AND 2B DETAILS	4/10/2011	4/20/2011	
C-63	PHASE 2A AND 2B DETAILS	4/10/2011	4/20/2011	
C-64	PHASE 2A AND 2B DETAILS	4/10/2011	4/20/2011	
C-65	PHASE 2A AND 2B DETAILS	4/10/2011	4/20/2011	
C-66	PHASE 2A AND 2B DETAILS	4/10/2011	4/20/2011	
C-67	PHASE 2A AND 2B DETAILS	4/10/2011	4/20/2011	
C-68	PHASE 2A AND 2B DETAILS	4/10/2011	4/20/2011	
C-69	PHASE 2A AND 2B DETAILS	4/10/2011	4/20/2011	
C-70	PHASE 2A AND 2B DETAILS	4/10/2011	4/20/2011	
C-71	PHASE 2A AND 2B DETAILS	4/10/2011	4/20/2011	
C-72	PHASE 2A AND 2B DETAILS	4/10/2011	4/20/2011	
C-73	PHASE 2A AND 2B DETAILS	4/10/2011	4/20/2011	
C-74	PHASE 2A AND 2B DETAILS	4/10/2011	4/20/2011	
C-75	PHASE 2A AND 2B DETAILS	4/10/2011	4/20/2011	
C-76	PHASE 2A AND 2B DETAILS	4/10/2011	4/20/2011	
C-77	PHASE 2A AND 2B DETAILS	4/10/2011	4/20/2011	
C-78	PHASE 2A AND 2B DETAILS	4/10/2011	4/20/2011	
C-79	PHASE 2A AND 2B DETAILS	4/10/2011	4/20/2011	
C-80	PHASE 2A AND 2B DETAILS	4/10/2011	4/20/2011	
C-81	PHASE 2A AND 2B DETAILS	4/10/2011	4/20/2011	
C-82	PHASE 2A AND 2B DETAILS	4/10/2011	4/20/2011	
C-83	PHASE 2A AND 2B DETAILS	4/10/2011	4/20/2011	
C-84	PHASE 2A AND 2B DETAILS	4/10/2011	4/20/2011	
C-85	PHASE 2A AND 2B DETAILS	4/10/2011	4/20/2011	
C-86	PHASE 2A AND 2B DETAILS	4/10/2011	4/20/2011	
C-87	PHASE 2A AND 2B DETAILS	4/10/2011	4/20/2011	
C-88	PHASE 2A AND 2B DETAILS	4/10/2011	4/20/2011	
C-89	PHASE 2A AND 2B DETAILS	4/10/2011	4/20/2011	
C-90	PHASE 2A AND 2B DETAILS	4/10/2011	4/20/2011	
C-91	PHASE 2A AND 2B DETAILS	4/10/2011	4/20/2011	
C-92	PHASE 2A AND 2B DETAILS	4/10/2011	4/20/2011	
C-93	PHASE 2A AND 2B DETAILS	4/10/2011	4/20/2011	
C-94	PHASE 2A AND 2B DETAILS	4/10/2011	4/20/2011	
C-95	PHASE 2A AND 2B DETAILS	4/10/2011	4/20/2011	
C-96	PHASE 2A AND 2B DETAILS	4/10/2011	4/20/2011	
C-97	PHASE 2A AND 2B DETAILS	4/10/2011	4/20/2011	
C-98	PHASE 2A AND 2B DETAILS	4/10/2011	4/20/2011	
C-99	PHASE 2A AND 2B DETAILS	4/10/2011	4/20/2011	
C-100	PHASE 2A AND 2B DETAILS	4/10/2011	4/20/2011	

1	1	1	1	1
4	4	4	4	4
3	3	3	3	3
2	2	2	2	2
1	1	1	1	1
NO	NO	NO	NO	NO

**P.U.P.S.**  
1-888-721-7877  
CALL BEFORE YOU DIG  
PALMETTO UTILITY  
PROTECTION SERVICE

**CEM**  
**ENGINEERING**  
P.O. BOX 2666 - PAWLEY ISLAND - SOUTH CAROLINA - 29585  
PHONE: 843-237-0001  
[www.CEMengineering.org](http://www.CEMengineering.org)  
PROJECT NO: 16076



DIFFERENCE SHOWN:

ORIGINAL BLDG LAYOUT JUNE 2017 (81 UNITS)  
 NEW BLDG LAYOUT OCT 2017 (80 UNITS)  
 REVISED BLDG LAYOUT MARCH 2018 (45 UNITS)  
 20 RESIDENTIAL ALLEY  
 UNIT BUILDING 3-1  
 BUILDING 5-1 REDUCED FOR 2 TO 3 UNITS  
 BUILDING 5-1 & 4-1 ARE TURNED SLIGHTLY

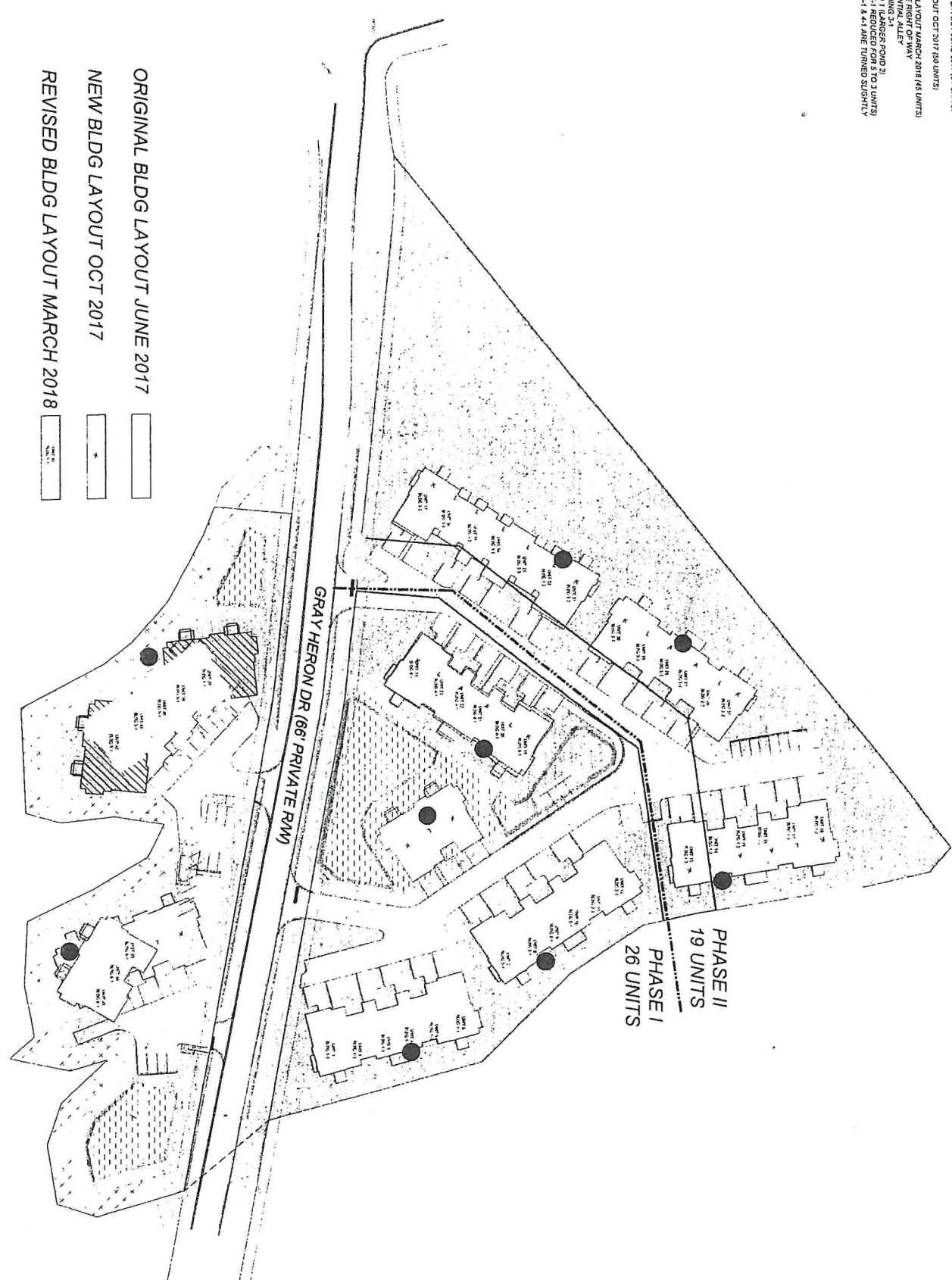

ORIGINAL BLDG LAYOUT JUNE 2017

NEW BLDG LAYOUT OCT 2017

REVISED BLDG LAYOUT MARCH 2018

PHASE II  
19 UNITS

PHASE I  
26 UNITS

GRAY HERON DR (66' PRIVATE R/W)

DYE CLUB TOWNHOMES  
 Horry County, North Myrtle Beach, SC  
 D.R. HORTON  
 BUILDING LAYOUT DIFFERENCES

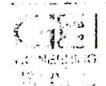

1	FOR SAMPLE OF LINE ADJUSTMENTS	MAX	3750.18
2	REV BLDG LAYOUT - DR HORTON	MAX	8000.17
3	TIE OFF WATER SERVICE & REMOVED - TRASH DETAIL	MAX	5100.17
4	REV FOR THE COMMENTS	MAX	4200.17

C-1.1



THAS 14200-01-054  
PIN# 35A-00-00-0017  
DYE COURSE @ BAREFOOT RESORT II LLC  
DB: 2458 PG: 1506

TEL: 813-931-01-034  
 FAX: 813-931-00-017  
 DYE COURSE @ BAREFOOT RESORTS LLC  
 DB: 7454 PG: 1306

LOT # 106  
PIN# 258-16-01-0003  
COASTAL RESORT HOLDINGS LLC  
256,980 Sq. Feet  
5.90 Acres

[illegible]

**DYE CLUB TOWNHOMES**

Horry County, City of North Myrtle Beach, SC

PREPARED FOR  
D.R. HORTON

PRELIMINARY PLAT



P.O. BOX 2685  
PAWLEYS ISLAND, SC 29585  
PHONE: 843.237.1001

www.G3Engineering.org



2	REV BLDG LAYOUT - DR HORTON	BAK	5/05-17	
2	TEE OFF WATER SERVICE & REMOVED - TRASH DETAIL	BAK	8/13-17	
1	REV PER TRC COMMENTS	BAK	6/2/17	
NO.	REVISIONS	BY	DATE	

SMET PP-1



0-2-17



### DRAINAGE LEGEND

- ## UTILITIES LEGEND

### SITE LAYOUT LEGEND

DESCRIPTION	EXISTING	PROPOSED
MAINLINE SEWER	5'	5'
MAINLINE SIZING	14" - 15"	14" - 15"
MANHOLE LOCATING	14" - 15"	14" - 15"
CLEANOUT	14" - 15"	14" - 15"
FINAL PUMP/STATIONARY	14" - 15"	14" - 15"
FORCE MAIN SIZING	14" - 15"	14" - 15"
OUTSIDE VALVE & BOX	14" - 15"	14" - 15"
HOUSE BIAS	14" - 15"	14" - 15"
OUTSIDE VALVE	14" - 15"	14" - 15"
FINAL CONNECTION	14" - 15"	14" - 15"
MAINLINE SEWER	14" - 15"	14" - 15"
MAINLINE SEWER	14" - 15"	14" - 15"

## IRVING, GRADING & DRAINAGE NOTES

IN FING SLEEVE & VALVE  
TELEPHONE

# WATER & SEWER UTILITY NOTES

- THE CONTRACTOR SHALL CONSTRUCT THE QUANTITY SPECIFIED, EQUAL SIZE LAKES AND DOKES FOR WATER AND FINE PROTECTION OF THE CITY OF KANSAS CITY PLANS. THE DOKING TO SHALL FURNISH ALL NECESSARY MATERIALS FOR THE WORK TO BE DONE. MEANS OF TRANSPORTATION AND LABOR NECESSARY TO COMPLETE THE WORK SHALL BE THE RESPONSIBILITY OF THE SPOON, DESIGNED AND REACH WATER AND SPIDER DEPARTMENT OF THE CITY OF KANSAS CITY. THE DOE IN THE EVENT THAT THE SPECIFICATION AND THE SPECIFICATIONS OF MOST SIMILAR SPECIFICATION SHALL GOVERN.

## GENERAL CONSTRUCTION NOTES

1. INTERVIEWED INDIVIDUALS, THEIR EMPLOYERS, AND OTHERS HAVE BEEN ASKED TO IDENTIFY THE CITY OF HOUSTON IN THE PAST FOR THE FOLLOWING: (1) COUNCIL, (2) BOARD, (3) COMMISSION, (4) OFFICE, (5) DEPARTMENT, (6) DIVISION, (7) AGENCY, (8) BUREAU, (9) DIVISION, (10) DEPARTMENT, (11) BOARD, (12) COMMISSION, (13) OFFICE, (14) DIVISION, (15) AGENCY, (16) BUREAU, (17) DIVISION, (18) DEPARTMENT, (19) BOARD, (20) COMMISSION, (21) OFFICE, (22) DIVISION, (23) AGENCY, (24) BUREAU, (25) DIVISION, (26) DEPARTMENT, (27) BOARD, (28) COMMISSION, (29) OFFICE, (30) DIVISION, (31) AGENCY, (32) BUREAU, (33) DIVISION, (34) DEPARTMENT, (35) BOARD, (36) COMMISSION, (37) OFFICE, (38) DIVISION, (39) AGENCY, (40) BUREAU, (41) DIVISION, (42) DEPARTMENT, (43) BOARD, (44) COMMISSION, (45) OFFICE, (46) DIVISION, (47) AGENCY, (48) BUREAU, (49) DIVISION, (50) DEPARTMENT, (51) BOARD, (52) COMMISSION, (53) OFFICE, (54) DIVISION, (55) AGENCY, (56) BUREAU, (57) DIVISION, (58) DEPARTMENT, (59) BOARD, (60) COMMISSION, (61) OFFICE, (62) DIVISION, (63) AGENCY, (64) BUREAU, (65) DIVISION, (66) DEPARTMENT, (67) BOARD, (68) COMMISSION, (69) OFFICE, (70) DIVISION, (71) AGENCY, (72) BUREAU, (73) DIVISION, (74) DEPARTMENT, (75) BOARD, (76) COMMISSION, (77) OFFICE, (78) DIVISION, (79) AGENCY, (80) BUREAU, (81) DIVISION, (82) DEPARTMENT, (83) BOARD, (84) COMMISSION, (85) OFFICE, (86) DIVISION, (87) AGENCY, (88) BUREAU, (89) DIVISION, (90) DEPARTMENT, (91) BOARD, (92) COMMISSION, (93) OFFICE, (94) DIVISION, (95) AGENCY, (96) BUREAU, (97) DIVISION, (98) DEPARTMENT, (99) BOARD, (100) COMMISSION, (101) OFFICE, (102) DIVISION, (103) AGENCY, (104) BUREAU, (105) DIVISION, (106) DEPARTMENT, (107) BOARD, (108) COMMISSION, (109) OFFICE, (110) DIVISION, (111) AGENCY, (112) BUREAU, (113) DIVISION, (114) DEPARTMENT, (115) BOARD, (116) COMMISSION, (117) OFFICE, (118) DIVISION, (119) AGENCY, (120) BUREAU, (121) DIVISION, (122) DEPARTMENT, (123) BOARD, (124) COMMISSION, (125) OFFICE, (126) DIVISION, (127) AGENCY, (128) BUREAU, (129) DIVISION, (130) DEPARTMENT, (131) BOARD, (132) COMMISSION, (133) OFFICE, (134) DIVISION, (135) AGENCY, (136) BUREAU, (137) DIVISION, (138) DEPARTMENT, (139) BOARD, (140) COMMISSION, (141) OFFICE, (142) DIVISION, (143) AGENCY, (144) BUREAU, (145) DIVISION, (146) DEPARTMENT, (147) BOARD, (148) COMMISSION, (149) OFFICE, (150) DIVISION, (151) AGENCY, (152) BUREAU, (153) DIVISION, (154) DEPARTMENT, (155) BOARD, (156) COMMISSION, (157) OFFICE, (158) DIVISION, (159) AGENCY, (160) BUREAU, (161) DIVISION, (162) DEPARTMENT, (163) BOARD, (164) COMMISSION, (165) OFFICE, (166) DIVISION, (167) AGENCY, (168) BUREAU, (169) DIVISION, (170) DEPARTMENT, (171) BOARD, (172) COMMISSION, (173) OFFICE, (174) DIVISION, (175) AGENCY, (176) BUREAU, (177) DIVISION, (178) DEPARTMENT, (179) BOARD, (180) COMMISSION, (181) OFFICE, (182) DIVISION, (183) AGENCY, (184) BUREAU, (185) DIVISION, (186) DEPARTMENT, (187) BOARD, (188) COMMISSION, (189) OFFICE, (190) DIVISION, (191) AGENCY, (192) BUREAU, (193) DIVISION, (194) DEPARTMENT, (195) BOARD, (196) COMMISSION, (197) OFFICE, (198) DIVISION, (199) AGENCY, (200) BUREAU, (201) DIVISION, (202) DEPARTMENT, (203) BOARD, (204) COMMISSION, (205) OFFICE, (206) DIVISION, (207) AGENCY, (208) BUREAU, (209) DIVISION, (210) DEPARTMENT, (211) BOARD, (212) COMMISSION, (213) OFFICE, (214) DIVISION, (215) AGENCY, (216) BUREAU, (217) DIVISION, (218) DEPARTMENT, (219) BOARD, (220) COMMISSION, (221) OFFICE, (222) DIVISION, (223) AGENCY, (224) BUREAU, (225) DIVISION, (226) DEPARTMENT, (227) BOARD, (228) COMMISSION, (229) OFFICE, (230) DIVISION, (231) AGENCY, (232) BUREAU, (233) DIVISION, (234) DEPARTMENT, (235) BOARD, (236) COMMISSION, (237) OFFICE, (238) DIVISION, (239) AGENCY, (240) BUREAU, (241) DIVISION, (242) DEPARTMENT, (243) BOARD, (244) COMMISSION, (245) OFFICE, (246) DIVISION, (247) AGENCY, (248) BUREAU, (249) DIVISION, (250) DEPARTMENT, (251) BOARD, (252) COMMISSION, (253) OFFICE, (254) DIVISION, (255) AGENCY, (256) BUREAU, (257) DIVISION, (258) DEPARTMENT, (259) BOARD, (260) COMMISSION, (261) OFFICE, (262) DIVISION, (263) AGENCY, (264) BUREAU, (265) DIVISION, (266) DEPARTMENT, (267) BOARD, (268) COMMISSION, (269) OFFICE, (270) DIVISION, (271) AGENCY, (272) BUREAU, (273) DIVISION, (274) DEPARTMENT, (275) BOARD, (276) COMMISSION, (277) OFFICE, (278) DIVISION, (279) AGENCY, (280) BUREAU, (281) DIVISION, (282) DEPARTMENT, (283) BOARD, (284) COMMISSION, (285) OFFICE, (286) DIVISION, (287) AGENCY, (288) BUREAU, (289) DIVISION, (290) DEPARTMENT, (291) BOARD, (292) COMMISSION, (293) OFFICE, (294) DIVISION, (295) AGENCY, (296) BUREAU, (297) DIVISION, (298) DEPARTMENT, (299) BOARD, (300) COMMISSION, (301) OFFICE, (302) DIVISION, (303) AGENCY, (304) BUREAU, (305) DIVISION, (306) DEPARTMENT, (307) BOARD, (308) COMMISSION, (309) OFFICE, (310) DIVISION, (311) AGENCY, (312) BUREAU, (313) DIVISION, (314) DEPARTMENT, (315) BOARD, (316) COMMISSION, (317) OFFICE, (318) DIVISION, (319) AGENCY, (320) BUREAU, (321) DIVISION, (322) DEPARTMENT, (323) BOARD, (324) COMMISSION, (325) OFFICE, (326) DIVISION, (327) AGENCY, (328) BUREAU, (329) DIVISION, (330) DEPARTMENT, (331) BOARD, (332) COMMISSION, (333) OFFICE, (334) DIVISION, (335) AGENCY, (336) BUREAU, (337) DIVISION, (338) DEPARTMENT, (339) BOARD, (340) COMMISSION, (341) OFFICE, (342) DIVISION, (343) AGENCY, (344) BUREAU, (345) DIVISION, (346) DEPARTMENT, (347) BOARD, (348) COMMISSION, (349) OFFICE, (350) DIVISION, (351) AGENCY, (352) BUREAU, (353) DIVISION, (354) DEPARTMENT, (355) BOARD, (356) COMMISSION, (357) OFFICE, (358) DIVISION, (359) AGENCY, (360) BUREAU, (361) DIVISION, (362) DEPARTMENT, (363) BOARD, (364) COMMISSION, (365) OFFICE, (366) DIVISION, (367) AGENCY, (368) BUREAU, (369) DIVISION, (370) DEPARTMENT, (371) BOARD, (372) COMMISSION, (373) OFFICE, (374) DIVISION, (375) AGENCY, (376) BUREAU, (377) DIVISION, (378) DEPARTMENT, (379) BOARD, (380) COMMISSION, (381) OFFICE, (382) DIVISION, (383) AGENCY, (384) BUREAU, (385) DIVISION, (386) DEPARTMENT, (387) BOARD, (388) COMMISSION, (389) OFFICE, (390) DIVISION, (391) AGENCY, (392) BUREAU, (393) DIVISION, (394) DEPARTMENT, (395) BOARD, (396) COMMISSION, (397) OFFICE, (398) DIVISION, (399) AGENCY, (400) BUREAU, (401) DIVISION, (402) DEPARTMENT, (403) BOARD, (404) COMMISSION, (405) OFFICE, (406) DIVISION, (407) AGENCY, (408) BUREAU, (409) DIVISION, (410) DEPARTMENT, (411) BOARD, (412) COMMISSION, (413) OFFICE, (414) DIVISION, (415) AGENCY, (416) BUREAU, (417) DIVISION, (418) DEPARTMENT, (419) BOARD, (420) COMMISSION, (421) OFFICE, (422) DIVISION, (423) AGENCY, (424) BUREAU, (425) DIVISION, (426) DEPARTMENT, (427) BOARD, (428) COMMISSION, (429) OFFICE, (430) DIVISION, (431) AGENCY, (432) BUREAU, (433) DIVISION, (434) DEPARTMENT, (435) BOARD, (436) COMMISSION, (437) OFFICE, (438) DIVISION, (439) AGENCY, (440) BUREAU, (441) DIVISION, (442) DEPARTMENT, (443) BOARD, (444) COMMISSION, (445) OFFICE, (446) DIVISION, (447) AGENCY, (448) BUREAU, (449) DIVISION, (450) DEPARTMENT, (451) BOARD, (452) COMMISSION, (453) OFFICE, (454) DIVISION, (455) AGENCY, (456) BUREAU, (457) DIVISION, (458) DEPARTMENT, (459) BOARD, (460) COMMISSION, (461) OFFICE, (462) DIVISION, (463) AGENCY, (464) BUREAU, (465) DIVISION, (466) DEPARTMENT, (467) BOARD, (468) COMMISSION, (469) OFFICE, (470) DIVISION, (471) AGENCY, (472) BUREAU, (473) DIVISION, (474) DEPARTMENT, (475) BOARD, (476) COMMISSION, (477) OFFICE, (478) DIVISION, (479) AGENCY, (480) BUREAU, (481) DIVISION, (482) DEPARTMENT, (483) BOARD, (484) COMMISSION, (485) OFFICE, (486) DIVISION, (487) AGENCY, (488) BUREAU, (489) DIVISION, (490) DEPARTMENT, (491) BOARD, (492) COMMISSION, (493) OFFICE, (494) DIVISION, (495) AGENCY, (496) BUREAU, (497) DIVISION, (498) DEPARTMENT, (499) BOARD, (500) COMMISSION, (501) OFFICE, (502) DIVISION, (503) AGENCY, (504) BUREAU, (505) DIVISION, (506) DEPARTMENT, (507) BOARD, (508) COMMISSION, (509) OFFICE, (510) DIVISION, (511) AGENCY, (512) BUREAU, (513) DIVISION, (514) DEPARTMENT, (515) BOARD, (516) COMMISSION, (517) OFFICE, (518) DIVISION, (519) AGENCY

**G3**  
ENGINEERING  
P.O. BOX 2668  
WILEYS ISLAND, SC 29585  
PHONE: 843.237.1001  
[www.G3Engineering.org](http://www.G3Engineering.org)

**DYE CLUB TOWNHOMES**  
HORRY COUNTY, NORTH MYRTLE BEACH, SC  
PREPARED FOR  
D.R. HORTON

---

GENERAL NOTES AND LEGEND

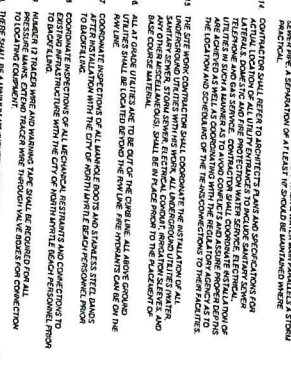
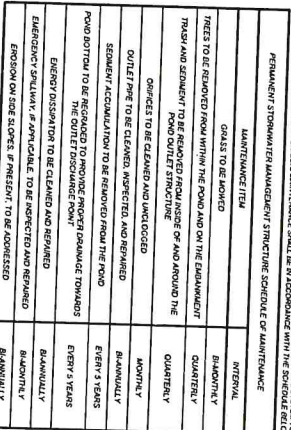

DETAIL / SECTION CALLOUT

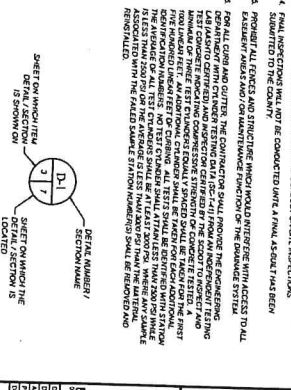



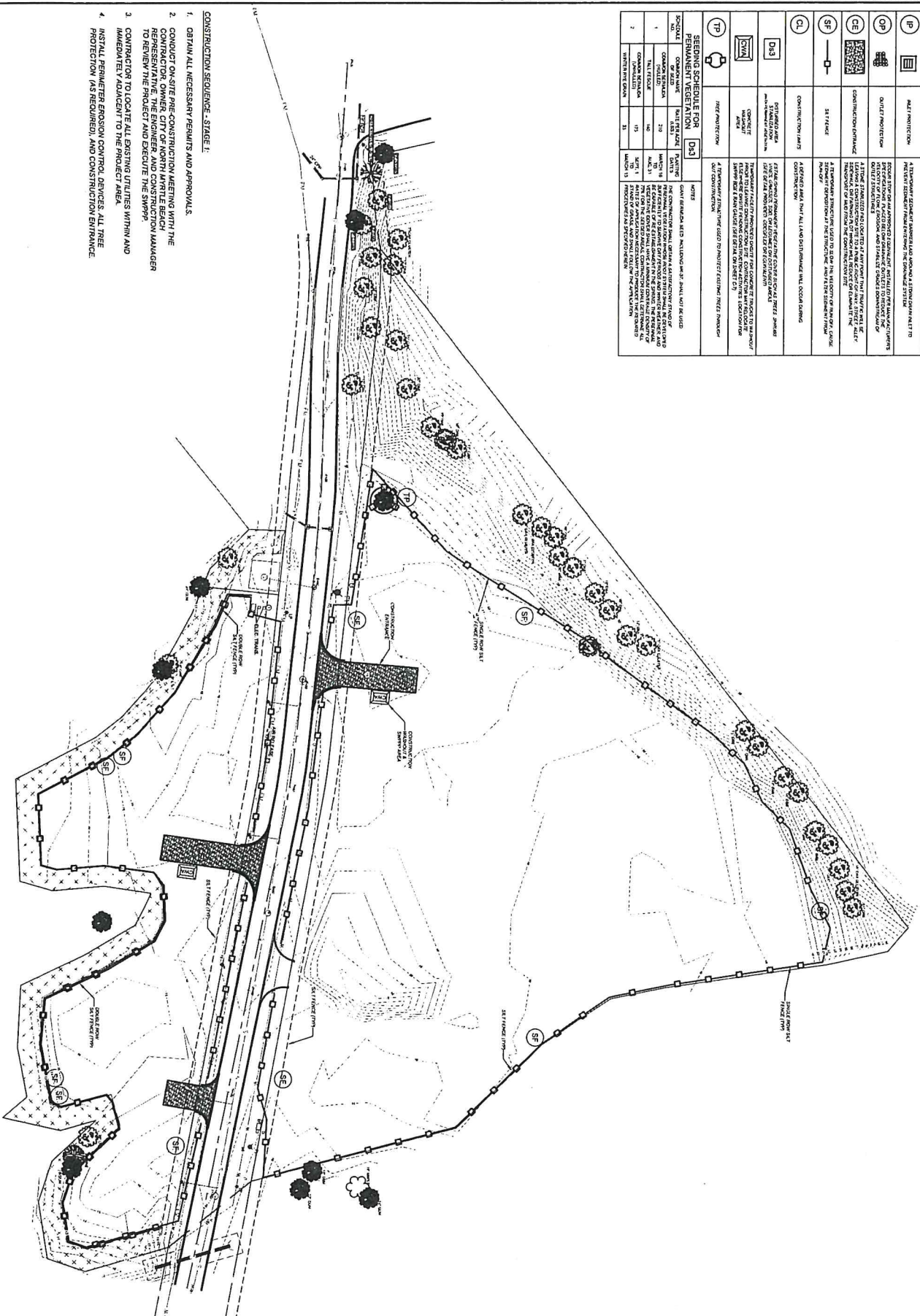

1. OBTAIN ALL NECESSARY PERMITS AND APPROVALS.
2. CONDUCT ON-SITE PRE-CONSTRUCTION MEETING WITH THE CONTRACTOR, OWNER, CITY OF NORTH AVARILE BEACH REPRESENTATIVE, THE ENGINEER AND CONSTRUCTION MANAGER TO REVIEW THE PROJECT AND EXECUTE THE SWPPP.
3. CONTRACTOR TO LOCATE ALL EXISTING UTILITIES WITHIN AND IMMEDIATELY ADJACENT TO THE PROJECT AREA.
4. INSTALL PERIMETER EROSION CONTROL DEVICES, ALL TREE PROTECTION (AS REQUIRED), AND CONSTRUCTION ENTRANCE.

HORRY COUNTY, NORTH MYRTLE BEACH, SC  
PREPARED FOR  
D.B. HORTON

**G3**  
ENGINEERING  
P.O. BOX 2668  
WLEYS ISLAND, SC 29585  
PHONE: 843.237.1001  
[www.G3Engineering.org](http://www.G3Engineering.org)



4	FEE SAMPLE LOT LINE ADJUSTMENTS	MAX	3/29/18	
3	REV BLDG LAYOUT - DR HORTON	MAX	9-05-11	
2	TEE OFF WATER SERVICES REMOVED - TRASH DETAIL	MAX	5/15/17	
1	REV PER TRC COMMENTS	MAX	4/27/17	
NO.	REVISIONS	BY	DATE	

**C-3**  
SHEET



SCALE: 1"=8'



0 20 40 60

DR. SCHAFFER, JAC

DRAWN: MURPHY

APPROVED: JAC

PROJ. NO. 14618

DATE: 6/23/17